

### Base di appoggio (acciaio zincato) - Foot support (zinc steel)

Tipo Type	A	B	C
P1	Ø206	50	Ø187
P2	Ø260	66	Ø228
P3	Ø275	76	Ø240
P4	Ø260	60	Ø145
P5	Ø320	80	Ø160
P6	Ø370	100	Ø180
P7	Ø420	125	Ø240
P8*	Ø500	150	-
P9	Ø650	216	Ø400

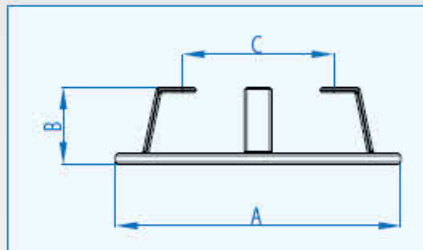

\* innesto a baionetta - bayonet joint

### Flangia filettata a collare - Threaded coupling flange with thread

#### Caratteristiche generali

- Filettate internamente, flangiate secondo norma ex UNI 2788
- Corpo in acciaio zincato
- Corredata da viteria inox

#### Main specifications

- Internal threaded, flanged according with ex UNI 2788 norms
- Body made of zinc steel
- Stainless steel screw / bolt included

Tipo - Type	DN-PN	G
F1*	65-6	2" 1/2
F5	65-10	2" 1/2
F2	80-16	3"
F3	100-16	4"
F4	150-16	6"



\*Flangia quadra - Square flange